

CERTIFIED LAND CORNER RECORDATION

DESCRIPTION OF CORNER EVIDENCE FOUND, AND ORIGINAL RECORD (If known)

¼ corner 22/27 T.13 N., R.63 W., 6th P.M., Laramie County, Wyoming
 Found 6" x 9" x 12" Granite Stone marked ¼ on south side. Well set

DESCRIPTION OF MONUMENT AND ACCESSORIES ESTABLISHED
 TO PERPETUATE THE ORIGINAL LOCATION OF THIS CORNER:

Left Stone in place
 Chiseled x on top of stone

SKETCH, WITH COURSE AND DISTANCE TO ADJACENT CORNER IF DETERMINED IN THIS SURVEY.
 (May Sketch or Paste Reproduction on Reverse Side.)

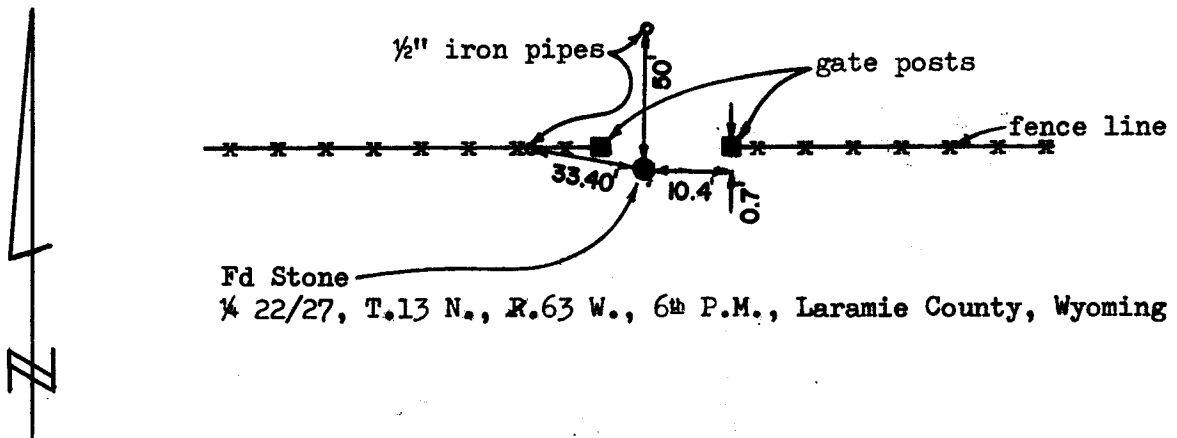

I, Robert C. Carbert certify that I have carefully performed or reviewed the work done on the programmed corner as reported on this recordation form and approve the same.

Robert C. Carbert
 Signature of Surveyor

495
 Registration No.

STATE OF WYOMING,
 Office of Clerk and Recorder,
 County of Laramie

This "corner record" was filed for record on the 6 day of January, 1975, was noted on the cross-index plat and is assigned page No. _____, in book No. _____

County Official

Cross Index No. <u>R 15</u>	T. <u>13</u>	R. <u>63</u>	<u>6</u> Mer.
_____	T. _____	R. _____	Mer.
_____	T. _____	R. _____	Mer.
_____	T. _____	R. _____	Mer.
_____	T. _____	R. _____	Mer.
_____	T. _____	R. _____	Mer.
_____	T. _____	R. _____	Mer.

Photographed
Indexed
Posted
Assessor

The State of Wyoming }
County of Laramie } 66
This instrument was filed for record
at 128 o'clock P M. on the
6 day of January
A. D. 1975 and duly recorded in
Book _____ on page _____

James C. Williams
County Clerk
By *[Signature]* Deputy